

## Hull Anodes

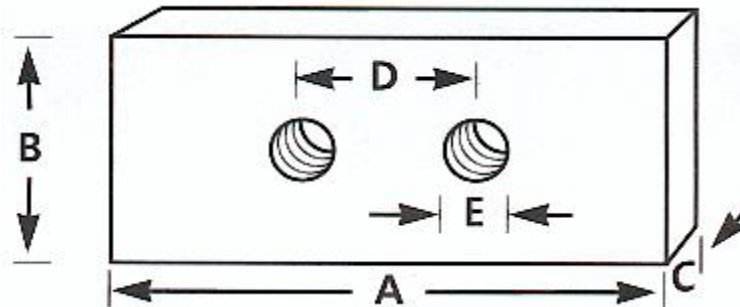

Part No.	A	B	C	D	E	Weight (Lbs)
T-20	3-1/2"	1-3/4"	1-3/8"	1-1/4"	1/4"	0.40
T-21	5-1/4"	2"	1"	1-5/8"	1/4"	1.00
MDZC-406	8-5/8"	4-1/4"	1"	N/A	1/4"	6.75
M-24	4-3/4"	2"	3/4"	1-1/4"	1/4"	0.53
M-25	9-1/4"	3-3/8"	3/4"	3-7/8"	1/4"	3.92
Z-404	9-1/4"	3-3/8"	3/4"	N/A	1/4"	3.25
M-30	6-1/4"	2-3/4"	5/8"	4-3/4"	1/4"	2.00
M-40	7-1/2"	2-3/4"	1/2"	1-3/8"	1/4"	2.08
ZHC-2	5-3/4"	2-1/2"	3/4"	2-3/4"	1/2" x 3/4"	2.15
ZHC-3	6-1/4"	2-3/4"	3/4"	2-1/4"	1/2" x 3/4"	2.00
ZHC-5	8"	4"	3/4"	4-3/8"	1/2" x 3/4"	4.80
DD 6x12	12"	6"	1/2"	2-1/2" x 8-1/2"	4"x1/2"	8.20



**From Ounces to Tons**  
 No job too big or too small

390 Millen Road, Rear Unit, Stoney Creek, Ontario, L8E 2P7

Toll free 866-979-7911 Phone 905 662 9143 Fax 905 385 2614

Email: [info@alchemyextrusions.com](mailto:info@alchemyextrusions.com)

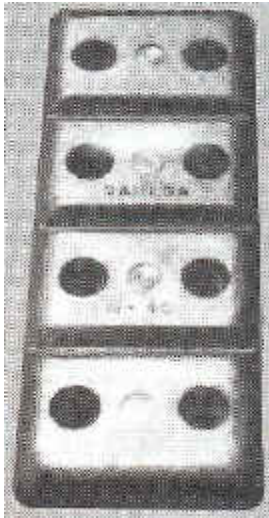

**M-40**

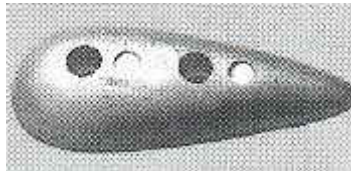

**T-20 & T-21**

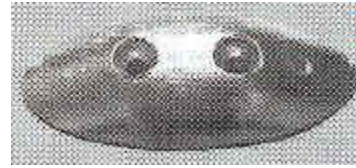

**M-24**



**M-25**



**Z-404**



**ZC-406**



**M-30**



**DIVER'S DELITE**



**ZHC-2, ZHC-3, ZHC-5**



**THE GROUPE**